

### Steps

Prices based on 30 mile radius of plant and do not include sales tax.

		Width							
		4	5	6	7	8	10	4	5
1 Riser	Plain Concrete	\$395.00	\$455.00	\$515.00	\$575.00	N/A	N/A	\$600.00	\$680.00
	Brick Faced	\$595.00	\$665.00	\$735.00	\$805.00	N/A	N/A	N/A	N/A
	Brick & Granite	N/A	\$1,125.00	\$1,280.00	N/A	N/A	N/A	N/A	N/A
	Stone & Granite	N/A	\$1,200.00	\$1,360.00	N/A	N/A	N/A	N/A	N/A
2 Riser	Plain Concrete	\$495.00	\$575.00	\$655.00	\$735.00	\$815.00	\$975.00	\$705.00	\$805.00
	Brick Faced	\$825.00	\$925.00	\$1,025.00	\$1,125.00	\$1,225.00	\$1,425.00	N/A	N/A
	Brick & Granite	N/A	\$1,475.00	\$1,680.00	N/A	\$2,065.00	N/A	N/A	N/A
	Stone & Granite	N/A	\$1,585.00	\$1,800.00	N/A	\$2,205.00	N/A	N/A	N/A
3 Riser	Plain Concrete	\$595.00	\$695.00	\$795.00	\$895.00	\$995.00	\$1,195.00	\$810.00	\$930.00
	Brick Faced	\$1,055.00	\$1,185.00	\$1,315.00	\$1,445.00	\$1,575.00	\$1,835.00	N/A	N/A
	Brick & Granite	N/A	\$1,825.00	\$2,080.00	N/A	\$2,560.00	N/A	N/A	N/A
	Stone & Granite	N/A	\$1,970.00	\$2,240.00	N/A	\$2,750.00	N/A	N/A	N/A
4 Riser	Plain Concrete	\$695.00	\$815.00	\$935.00	\$1,055.00	\$1,175.00	\$1,415.00	\$915.00	\$1,055.00
	Brick Faced	\$1,285.00	\$1,445.00	\$1,605.00	\$1,765.00	\$1,925.00	\$2,245.00	N/A	N/A
	Brick & Granite	N/A	\$2,175.00	\$2,480.00	N/A	\$3,055.00	N/A	N/A	N/A
	Stone & Granite	N/A	\$2,355.00	\$2,680.00	N/A	\$3,295.00	N/A	N/A	N/A
5 Riser	Plain Concrete	\$805.00	\$945.00	\$1,085.00	\$1,225.00	\$1,365.00	\$1,645.00	\$1,020.00	\$1,180.00
	Brick Faced	\$1,515.00	\$1,705.00	\$1,895.00	\$2,085.00	\$2,275.00	\$2,655.00	N/A	N/A
	Brick & Granite	N/A	\$2,525.00	\$2,880.00	N/A	\$3,550.00	N/A	N/A	N/A
	Stone & Granite	N/A	\$2,740.00	\$3,120.00	N/A	\$3,840.00	N/A	N/A	N/A
6 Riser	Plain Concrete	\$915.00	\$1,075.00	\$1,235.00	\$1,395.00	\$1,555.00	\$1,875.00	\$1,125.00	\$1,305.00
	Brick Faced	\$1,745.00	\$1,965.00	\$2,185.00	\$2,405.00	\$2,625.00	\$3,065.00	N/A	N/A
	Brick & Granite	N/A	\$2,875.00	\$3,280.00	N/A	\$4,045.00	N/A	N/A	N/A
	Stone & Granite	N/A	\$3,135.00	\$3,570.00	N/A	\$4,395.00	N/A	N/A	N/A
7 Riser	Plain Concrete	\$1,025.00	\$1,205.00	\$1,385.00	\$1,565.00	\$1,745.00	\$2,105.00	\$1,230.00	\$1,430.00
	Brick Faced	\$1,975.00	\$2,225.00	\$2,475.00	\$2,725.00	\$2,975.00	\$3,475.00	N/A	N/A
	Brick & Granite	N/A	\$3,225.00	\$3,680.00	N/A	\$4,540.00	N/A	N/A	N/A
	Stone & Granite	N/A	\$3,520.00	\$4,010.00	N/A	\$4,940.00	N/A	N/A	N/A

### Rails

	42" Plat	No Plat	Side Entry
1 Riser	\$325.00	N/A	N/A
2 Riser	\$365.00	\$270.00	\$555.00
3 Riser	\$425.00	\$305.00	\$585.00
4 Riser	\$480.00	\$375.00	\$620.00
5 Riser	\$530.00	\$440.00	\$655.00
6 Riser	\$585.00	\$525.00	\$690.00
7 Riser	\$645.00	\$575.00	\$720.00

### Miscellaneous

Banking Steps	\$730.00
Angle Iron Brackets	\$70.00
Backed Poured In	\$200.00
Remove & Dispose of Precast Stairs	\$250.00
Return Trip	\$100.00
Reset (Minimum 1 Hr)	\$110.00
QMC (Minimum 1 Hr)	\$125.00

Platform Depth 42" Standard (60" on side entry)  
 Not responsible for damage beyond curb line including lawn.  
 Not responsible for damage beyond curb line; including lawn.

Stair Measurements may vary up to 1/2 inch.  
 20% handling charge on all returned goods.  
 Prices are subject to change without notice

IMPORTANT: DO NOT use salt or deicing products on stairs.

Updated June 6, 2011

# Bulkheads

Prices based on 30 mile radius of plant and do not include sales tax.

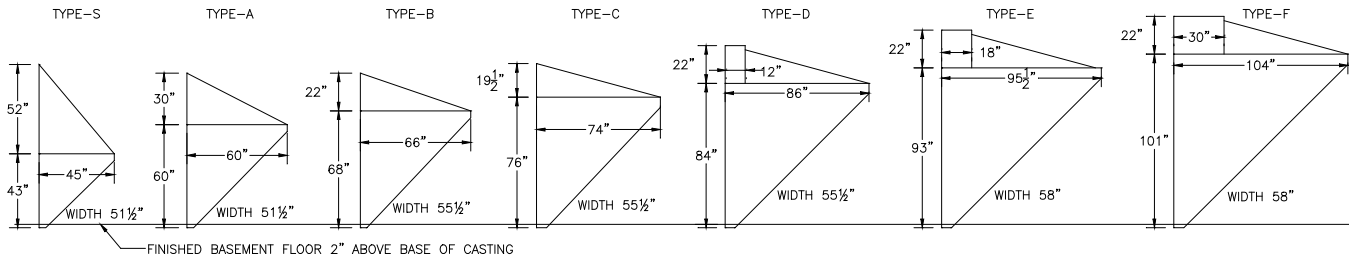

Type	Concrete Height	Concrete w/Door	Concrete Only	Door Installed	Door Only
S	43"	\$1,375.00	\$990.00	\$670.00	\$550.00
A	60"	\$1,315.00	\$1,015.00	\$605.00	\$490.00
B	68"	\$1,385.00	\$1,100.00	\$605.00	\$490.00
C	76"	\$1,480.00	\$1,155.00	\$650.00	\$530.00
D	84"	\$1,670.00	\$1,205.00	\$845.00	\$695.00
E	93"	\$2,105.00	\$1,700.00	\$875.00	\$725.00
F	101"	\$2,410.00	\$1,995.00	\$955.00	\$810.00

## Extensions

12"	\$165.00
18"	\$200.00
30"	\$290.00

## Bulkhead Door Lock

Installed with Unit	\$160.00
Picked up	\$80.00

## Brackets for Block Wall

\$110.00

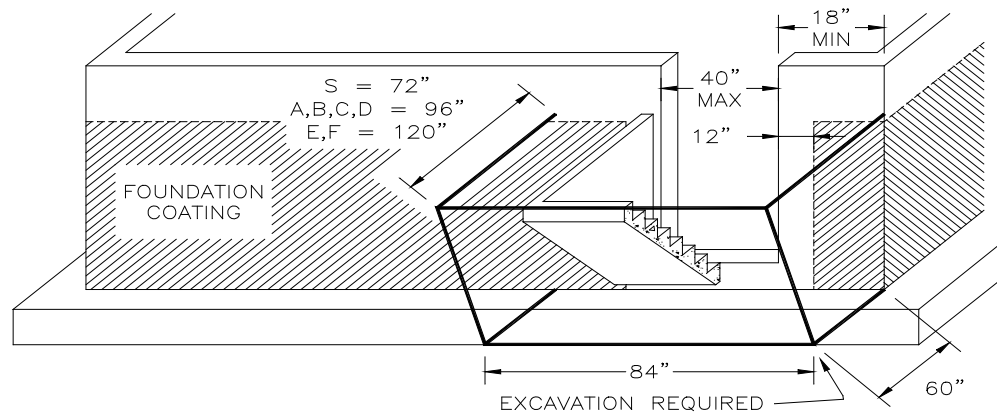

## Bulkhead Installation Requirements:

- 1) Keep foundation sealer a minimum of 12" from opening.
- 2) Pour a minimum of a 11 1/2" sep in bulkhead opening as shown.
- 3) Keep a Minimum of 18" from foundation corner.
- 4) Roof drainage should be diverted away from bulkhead opening.
- 5) Perimeter drainage required.
- 6) Back fill should be clean gravel well compacted.
- 7) How to order: Determine dimension from top of footing to proposed finished grade. Refer to types available and select size to assure top of stairwell will be 2" to 6" above finished grade.

Prices are subject to change without notice.

Remove and Dispose of bulkhead - \$400

Return to job and/or work above and beyond project scope - \$125/hr

Small deliveries \$100 delivery charge.

20% handling charge on all returned goods.

Updated June 6, 2011